

EXISTING SITE PLAN

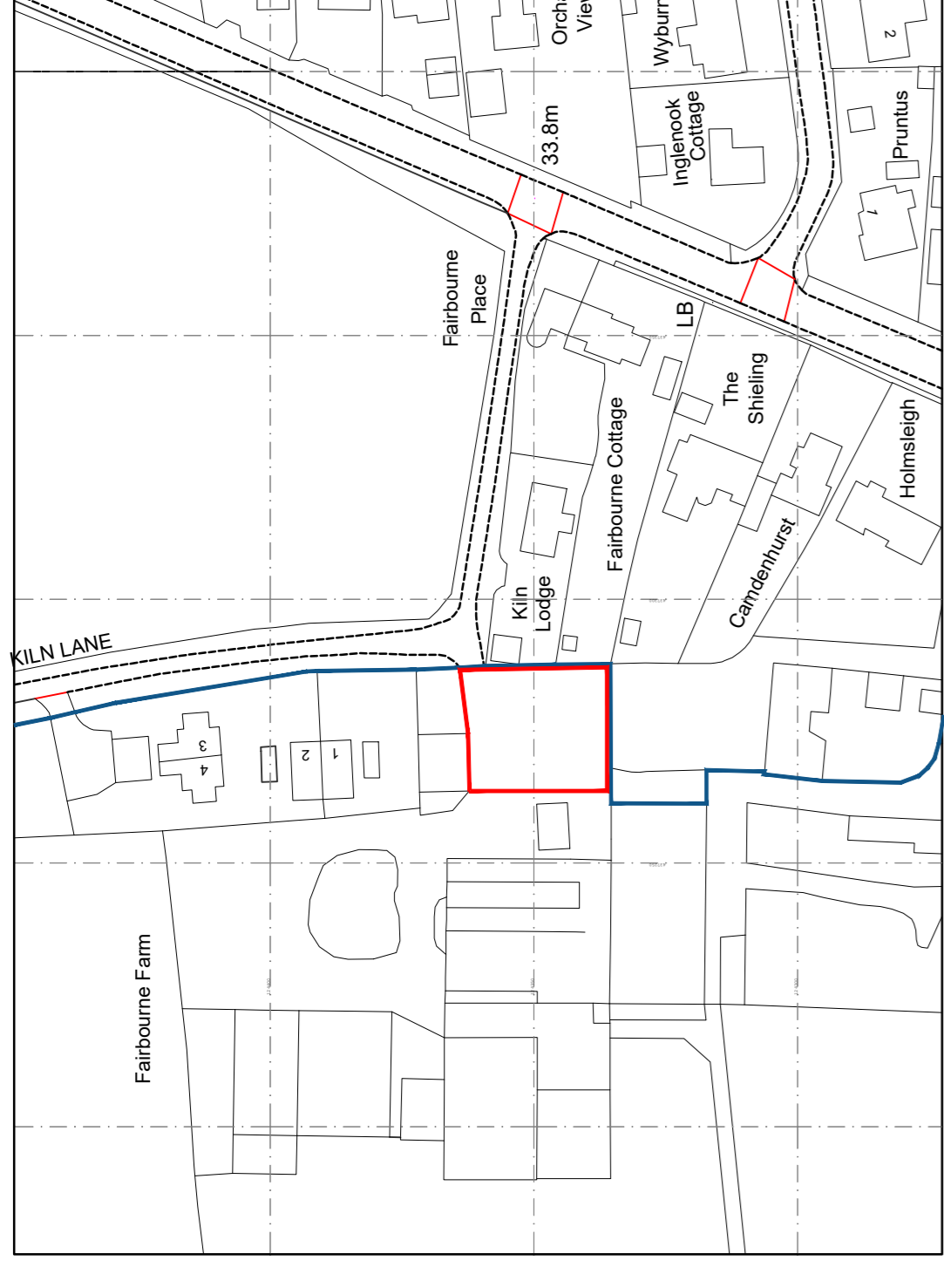

PROPOSED SITE PLAN

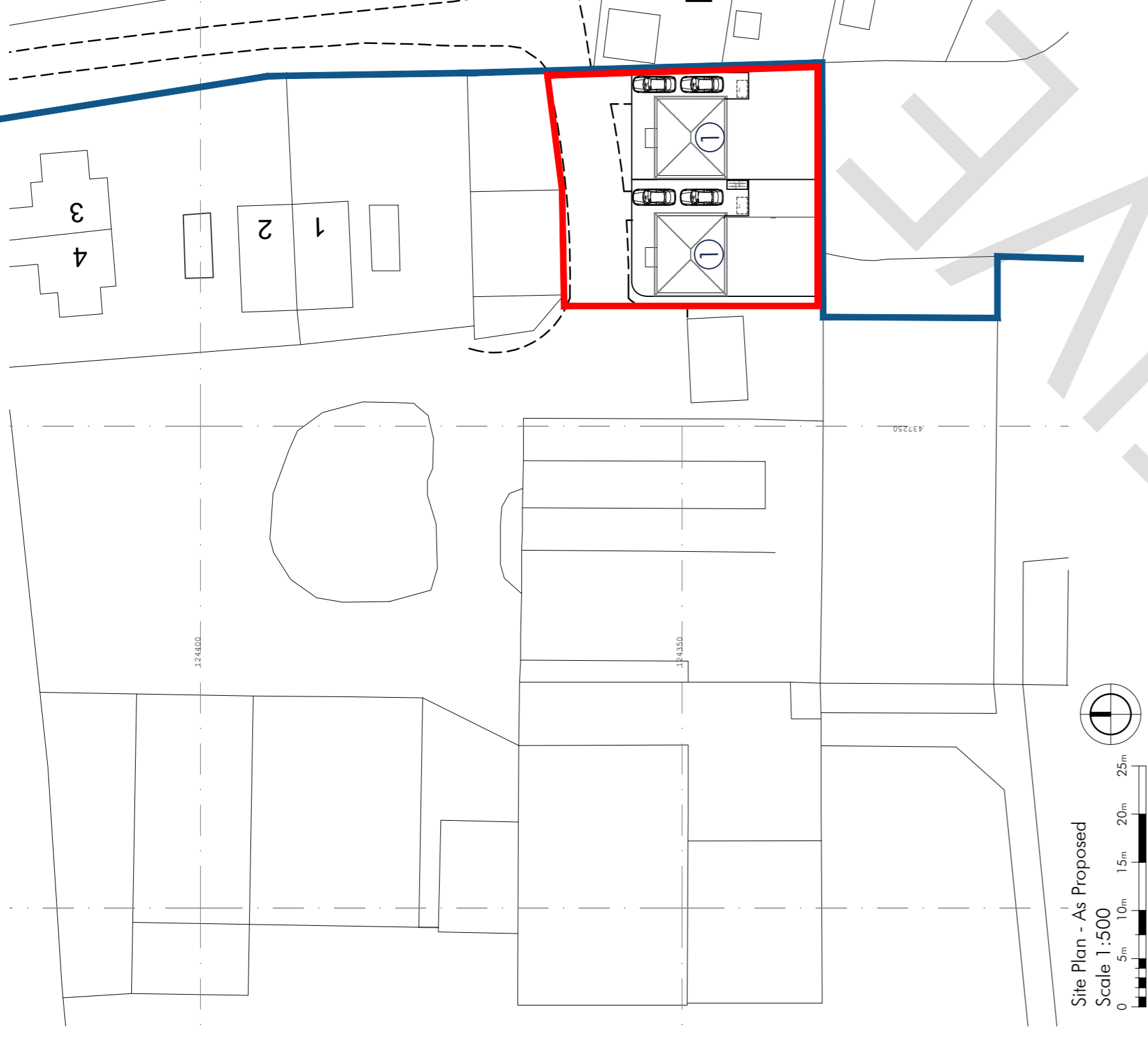

Chartered Surveyors (UK) Copyright 2022. All rights reserved. Licence number 100224242

Location Plan - As Existing
Scale 1:1250

PROPOSED BLOCK PLAN

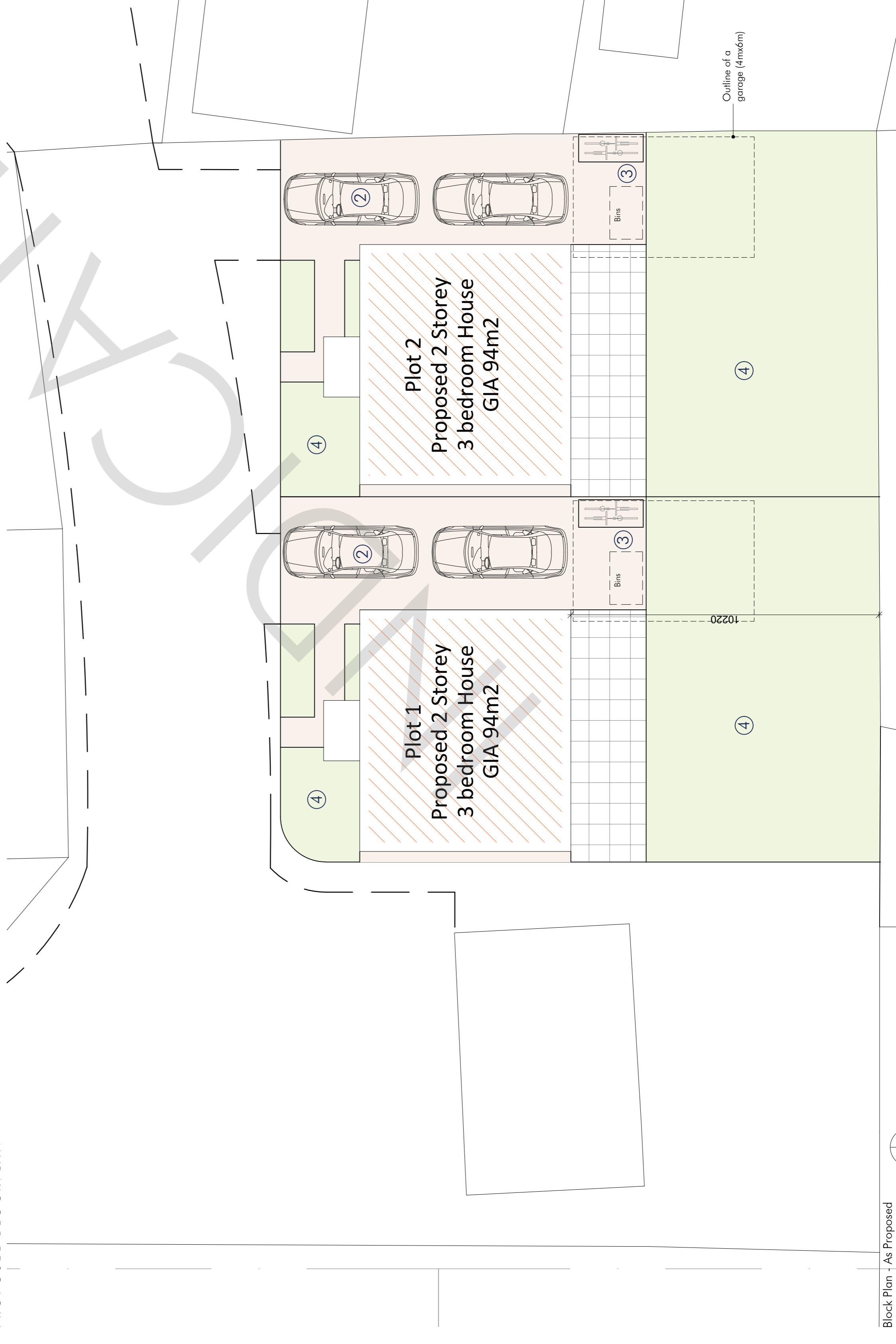

NOTES

- Two new proposed 3 bedroom detached houses ①
- Proposed parking for 2 cars per property ②
- Provision of a cycle & bin store ③
- Provision of front and rear garden ④

SIZES

- Plot 1 Property Site Area: 240m²
- Plot 1 Property Garden Area: 114m²
- Plot 1 Property Area: GEA 56m²
- Plot 2 Property Site Area: 238m²
- Plot 2 Property Garden Area: 114m²
- Plot 2 Property Area: GEA 56m²

No.	Description	Date
A	Boundary Adjusted	02.11.2022

SC Architecture
Anchor House, School Lane
Chandlers Ford, Eastleigh
Hampshire SO53 4DY

T: 023 8026 9222
E: info@scarchitecture.co.uk
W: www.sc-architecture.co.uk

RIBA
Chartered Practice

Drawing Title:
Indicative Plans
As Existing & Proposed

Project Title:
Fairbourne Farm
Brashfield
Romsey

Drawing No.:
4408-PA-101

Revision:	A
Date:	October 2022
Scale:	As Shown
Drawn:	HLE
Checked:	MSS

This drawing is the copyright of the company and must not be reproduced or used without permission. Annotated dimensions are to be taken in preference to scaled dimensions and site dimensions must be checked before work is commenced.